

THE JOURNEY

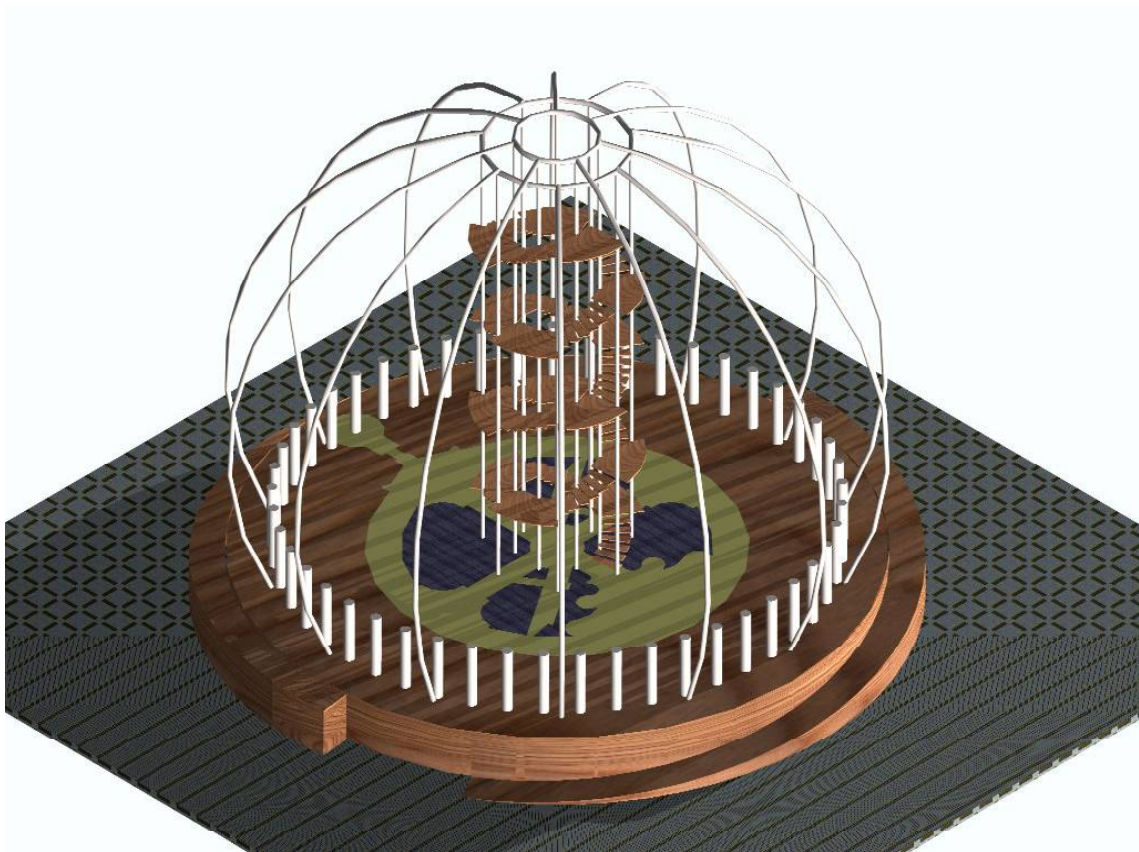

“THE JOURNEY”

The exhibition is composed by 3 fazes:

- I – The past – the base of the vessel (continents, oceans and the astrolabe)
- II – The present – the voyageurs (the pillars of the vessel – 7 major’s arts)
- III- The future – the skies and the stars ballet (music and rayon’s laser)

For the materialization of the exhibition we need the plastics arts, the history, the poetry and the music. From their interconnection we want create a space where dream is allowed. Almost “realistic”.

Central idea – A long time ago the earth was an immense Paradise. In it they had lived the “gods”, and they go to count its memories from the past, the present and the future. These memories give in the description of the time where de god’s travelled for the future (where everything are contained) with faster that the light, greater that the time.

As well as today, they arrive until us, histories human and mythological’s, that they from our memory, also god’s, of these remote era, survivors to an interplanetary cataclysm, leave in its memories of these era without hurry. All the history that he goes to tell is established in the reading of the Fernando Pessoa “the message”, she is mere intuitive; personal and does not intend itself to have any severity: who concerns the utilisation of the number seven; we only intended to lunch a climate of mysticism to each one.

Physic space – The half of the circle is the remaining portions of the ship where if they carried the goods rough and imprisoned in the earth. Into it a possible beginning of script of a return trip is insinuated (suggested). In this ship the physicist (land) and the dream are contained in simultaneous (one simulacrum of a lowermost part of the Universe contained in one all).

In it they exist the past, the present and the future.

Base of the semicircle – Everything is transferred in waking up and to reconstruct of the goods that due to the cataclysm that they had provoked when of its fall on the earth (the fall of the second of the two moons, presents in some religions), the great diluvium, they start to reorganize itself to follow trip. These continents are represented by goods of the mythology Greek and according to a preset order:

Europe, Ares, Icaro, Asia, Artemisia, Poseidon and Aphrodite

We use the number seven in the following way:

7 empires had been chosen

- 1st - Fire
- 2nd - Water
- 3rd - Air
- 4th - Earth
- 5th - Man
- 6th - Ascension
- 7th - Light

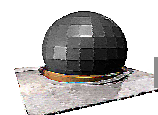

Each one of these empires has 7 attributes:

- 7 Colours
- 7 Oceans
- 7 Skies
- 7 Continents
- 7 Bigger arts
- 7 Musical notes
- 7 Spirals

Also for the 7 heavens we have given 7 attributes:

- 1st - Physical
- 2nd - Emotional
- 3rd - Mental
- 4th - Faith
- 5th - Divine conscience
- 6th - Creativity/Inspiration
- 7th - Paradise

For the evolution of the Planet Earth it is necessary to cover a way that starts in Fire and finishes in Light

In the soil of the ship, it is intended to insinuate the image of the astrolabe that will be the instrument of space navigation that will guide the goods in the trip of return to the future. The seas where they seat the goods have the respective colour of the continents. Then they leave vapour clouds and spirals of light of the same colour.

Spaceship – Is composed by 49 columns (travellers) where we counts the history of the terrestrial ones that they had been elected for the goods, as helping in the task to reconstruct the ship, thus to be able to initiate the trip of return through the space. These travellers will be 7 representatives of each one of the 7 bigger arts.

- Architecture
- Sculpture
- Painter
- Dance
- Poetry
- Music
- Cinema

Each column (1st of each art) is a colour of the Rainbow. It will become linking with the intermediate colours (degrade). In it the history of respective traveller will hear. As well as it will have an image in it. In the top of a mountain of the ship a black hole exists (of that it will be said more ahead). This black hole is intended that symbolizes the ticket door, that it will allow each one to initiate its trip of return, as it desires it.

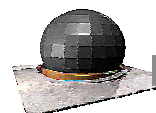

HAVENS

In the sky of the ship 7 havens exists. Each one of is colour. Each one with one constellation. Each one corresponds to a continent and each constellation has 7 stars. Each continent it leaves a spiral that will make the linking respective constellation between a chosen Star.

BALLET OF THE STARS

The constellation represents the aids (messengers) that they are sent to help us (to guide us) in our trip until home. They are the celestial advisers.

It's now the beginning of a new dream, new trip and new story.

Whit the constellations we will, with the help of laser rayon's try to transmit the bustle in the havens without end exists to make the earth be "raised".

Those bustle as the proposal to complete the universe which is in expansion until finally he is concluded (a new world).

Another's planets exist in the some fight as the earth. Also in them the principal's regents they had rebelled. Also in them others souls are fighting to be completed (to join the physical whit the spiritual).

The terrestrial will conquer in the new world is own place. Place which will be very special, because as they never have seen the Universe (never have been in the paradise) by is faith (when its is strong) they accepted Him unconditionally and it put to its service.

Latter, when it comes an opportunity, we will write about this "Ballet of the Stars. For it is necessary the music (6th Empire).

On the creation of the havens there are two principals' ideas, The Mortal and The Divine. The result of their perfect union becomes a new light be (7th Empire).

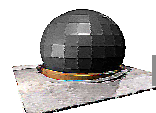

I – THE PAST

The floor of the ship

First Image

Europe

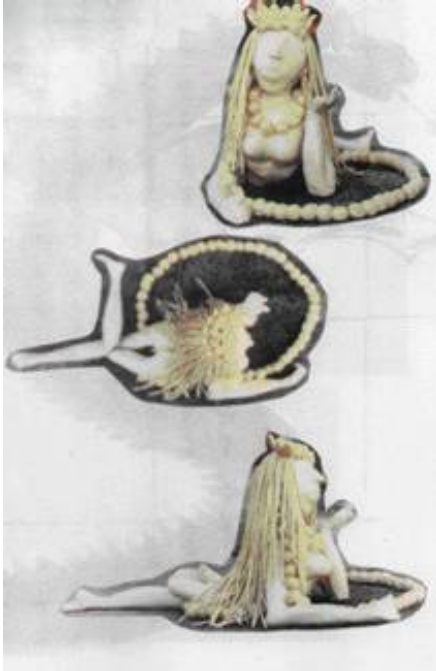

With woman figure is based in the poem of the “Message” “of the castles”. Colour Orange Auriga constellation.

She count the history of “The Message” (in the necklace are symbolized the Illustrious Portuguese of who Pessoa speaks).

The figure is lying of face down. Long had of hair. Wreath of flowers in the head. It is intended to give at the same time and superb air, scholar, patient and that she is an excellent accountant of histories we propose.

According to the Greek mythology Europe was a pretty virgin that it always resisted the desires of Zeus.

Not obtaining her conquer, Zeus decided to changed himself into a pretty white bull and he goes to the beach where he obtain his proposal .So, when she was banish from the paradise, she establish the Europe.

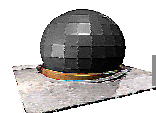

Second Image Africa (Good Ares)

With figure of a man who is recreating himself. The “The Message” chosen poem is “O desejado”. Colour red. Constellation Capricorns

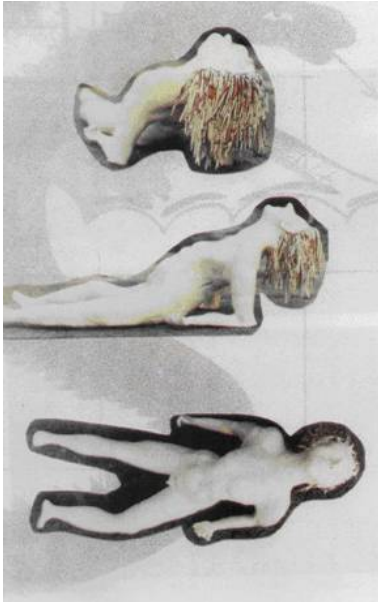

Third Image North of America (Icaro)

Man figure in departure to the race of 328, 08 feet. He has wing as Icaro that he represents. Colour yellow. Constellations bear lesser. The “The Message” chosen poem is “before daylight”

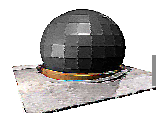

Fourth Image Asia

Women figure, followed (taking care of) of his four children (4 peninsulas, Indochina, China, India, Islamic). Green colour. Constellation bigger ursa. The “the Message” poem chosen is “Afonso de Albuquerque”

Asia is Ocean and Thetis daughter. She married whit Japto and they have four children - Atlas, Prometheus, Ipemeteu and Menecius.



Fifth Image South of America (Artemisia)

Woman figure with a sun on the brass, moon on her head, serpent on her arm. She represents a clearer of a new day .The “the Message” chosen poem is “night”. Colour blue. Cygnus constellation.

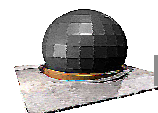
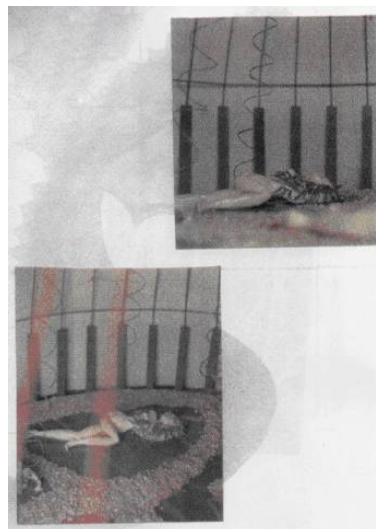

**Sixth Image
Oceania (Poseidon)**



Man figure, seated, supported in a fish, reclined against a rock and followed for small tritons (small islands). Suggest the Peace. The “The Message” chosen poem is “fortunate islands”. Colour indigo. Constellation Boots.



**Seventh Image
Atlantida (Aphrodite)**



Woman figure. Going up to the stars. Leaving the deep one of the ocean (appeared for the shells). The “the Message” chosen poem is “Fifth Empire”. Violet colour. Andromeda constellation.

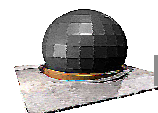

III - THE FUTURE

The Havens with the ballet of the Stars (Constellations, music, laser rayon's)

Then we were beginning to go up to the seven havens. Is the beginning of the future dream of which one. This claming have the hope of the adventure that "...calm" suggest us. With him we arrive to the black hole which is "...next and remote island...a guarded island appears...".

Than we go down by the Darwin spiral where we will be born again for then we start again a new stage.

This stage, once more in our existence and so many times as we will need to obtaining the asked excellence to go the island we looked-for.

First Haven (Physical)

Red colour. Capricornia's constellation. Africa continent. Empire fire. Sea Atlantic north. Musical note Do. Major art architecture.

Is the awake of the dark night. Is the beginning of the taking of the conscience of being itself a part of one all. Is the desire to growth further than himself beginnings to insinuate. Is the beginning of the recognising that exists something more for beyond the material and the physical. Is desire to treat the body wounds for than to treat the soul wounds. The chosen poem from "The Message" is "Prece"

Second Havens (Emotional)

Orange colour. Auriga constellation. Europe continent. Water Empire. Mediteranic Sea. Musical note Re. Major Art sculpture.

Is the hour to make questions, tom make a choice before him, to know the reason. Is growing inside. The chosen poem from the "The Message" is "The Third" of the part "The acknowledgments".

Third Haven (Mental)

Yellow colour. Minor bear. North of America continent. Air Empire. Pacific Ocean. Musical note Mi. Major Art Painter.

Is the time to take the decision of is conscience. Is the time to cement the will with clear. Is the time to make options. The "The Message" chosen poem is "occident".

Fourth Haven (Faith)

Green colour. Major Bear. Asia continent. Earth Empire. Indic Sea. Musical note Fa. Major art Dance.

Is the acceptance of mission realization that was destined. Is the acceptance and the surpass his difficulties. Is the conscience that they are the affirmation of his spiritual force. The "The message" chosen poem is "Vasco da Gama ascension".

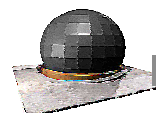

Fifth Haven (Divine conscience)

Blue colour. Cygnus constellation. South of America Continent. Man Empire. South Atlantic Sea. Major Art poesy.

Is the conscience that we belong to an all very large element. We exist behind the infinity. We belong of the universe expansion and we are contained on it. We are come here to create and participate of the evolution here proposal a paradise on earth, that we have a rare glimpse, but we already knows is existence and we expecting very anxiously .Is accepting that we are essential for is realization and know that he is not complete without us . All of us are essential on it. The “The Message” chosen poem is “Padrão”

Sixth Haven (Creativity/inspiration)

Anil color. Boots constellation. Océanie continent. Artic Sea. Ascensão Empire. Musical note La. Majeur Art Music.

Is the glimpse of the dream. Is the realization of the finals stages before arriving in the paradise. Is the arriving in the full happiness. Is the ending of is task.

The “the Message” chosen poem is “Horizonte”

Seventh Haven (Paradise)

Violet color. Andromède constellation. Atlanta continent Light Empire. Antarctic sea. Musical note Si. Major art Cinema

Is the arrival at home.

Is the renovation by the work at last well done.

Is the acceptation that we belong to an all one and only for it are justification to exist. Is be whit Him and be Him. Is the recharge of the energies until new worlds come to built.

Is to be completed on Him

The “The Message” chosen poem is “D. Sebastian”.

the author

Maria do Carmo Peixeiro

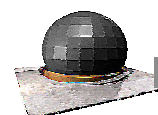

Installation description

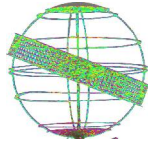

“The Journey” send-in us for a physical and spiritual passage that develops inside a circle and in circle. The circle, the most perfect form, representation of the absence of limits, the eternity and the absolute.

To grasp an orientation it is caught in symbolic number seven and through this a story is told which will be remade by each traveller.

By a straight, simple and symbolic way the circle and number seven give homogeneity to the environment where the story of “The Journey” is told.

The object

Externally the object is exempt of accessory elements, silver coloured, brilliant and spherical, mitigating the idea of heavenly vault, while the basement is brown and hot as the land.

In the interior it is perceived the wooden structure that stands out the black plate, the stairs that go up in spiral to nowhere and the forty nine columns that involve the circular space.

The slopes in the exterior determine an entrance and an exit, and analysed with the stairs point out to a long and difficult passage that will be surpassed in a different way by who undertakes the journey.

The materials

The aluminium is covering and the wood is floor. The wood is also structure and the perforated black steel plate which coats the interior contributes for the control of the luminosity and the acoustics.

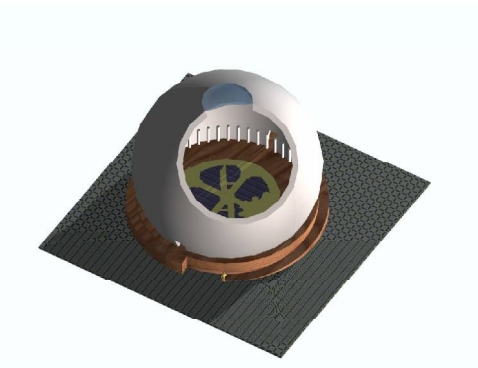
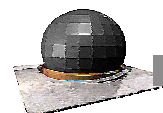

Accessibility

The accessibility is guaranteed by the exterior slopes and an elevatory chair in the stairs.

Constructive solution

The structure seats in 14 points concrete based that allow to fulfil the stability project and simultaneously they create space for the basement (the slopes) and support equipment.

Once the structure is dismantable the structural wood elements have metallic unions to allow transportable dimensions.

The covering presents good functioning characteristics under any climatic condition, protecting efficiently the equipment to install in the space.

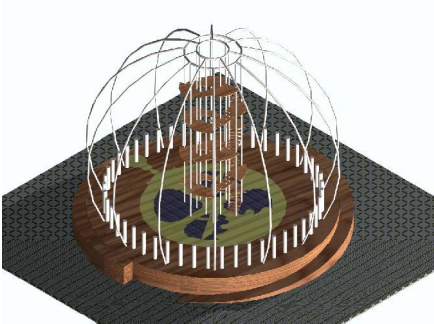

the architect

Castro Grilo

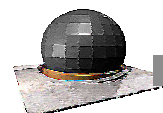
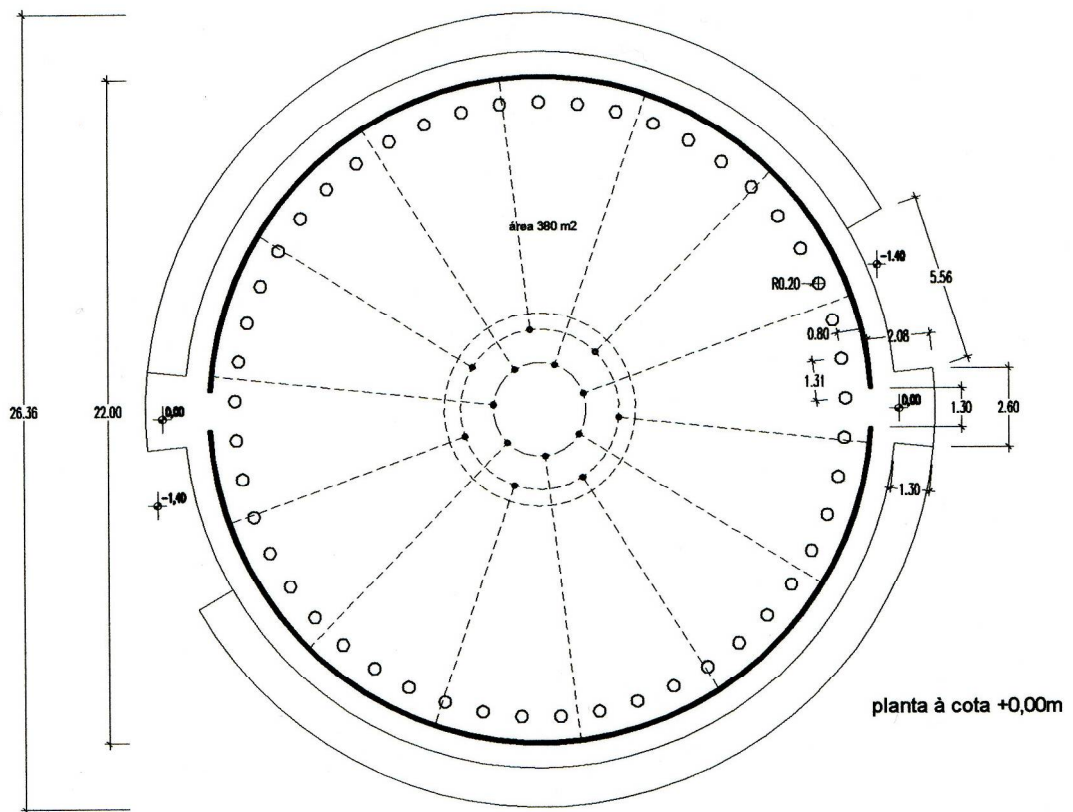
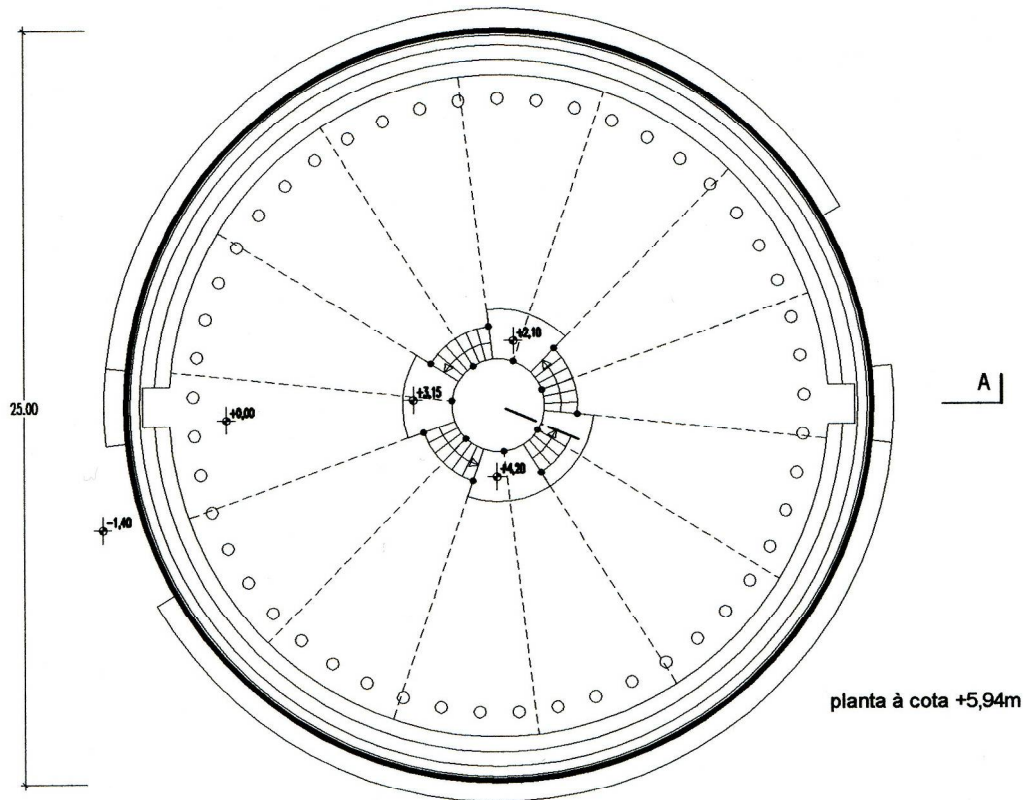

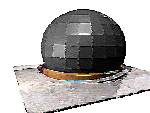
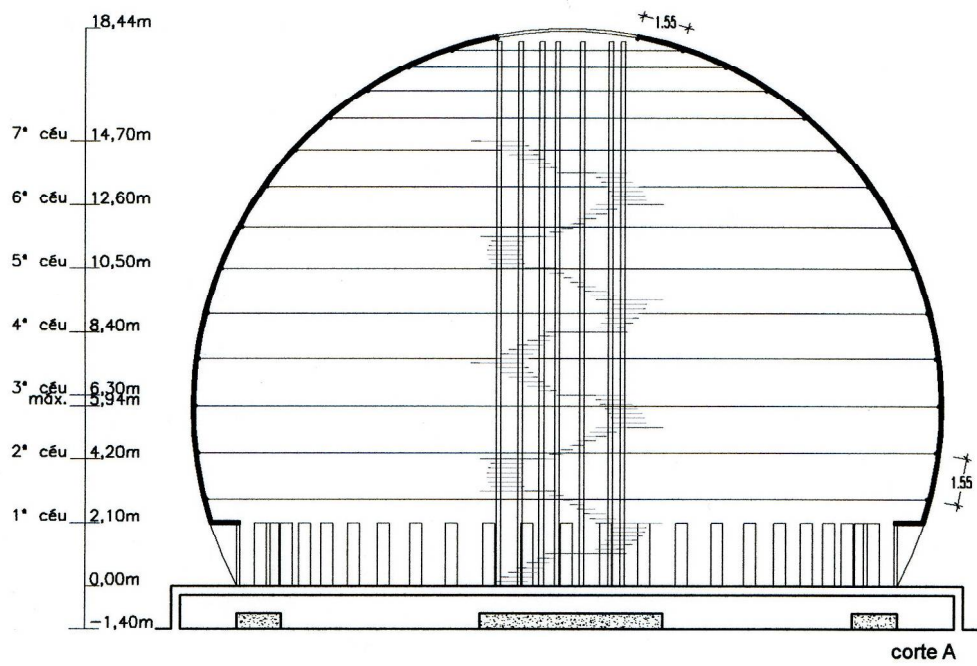

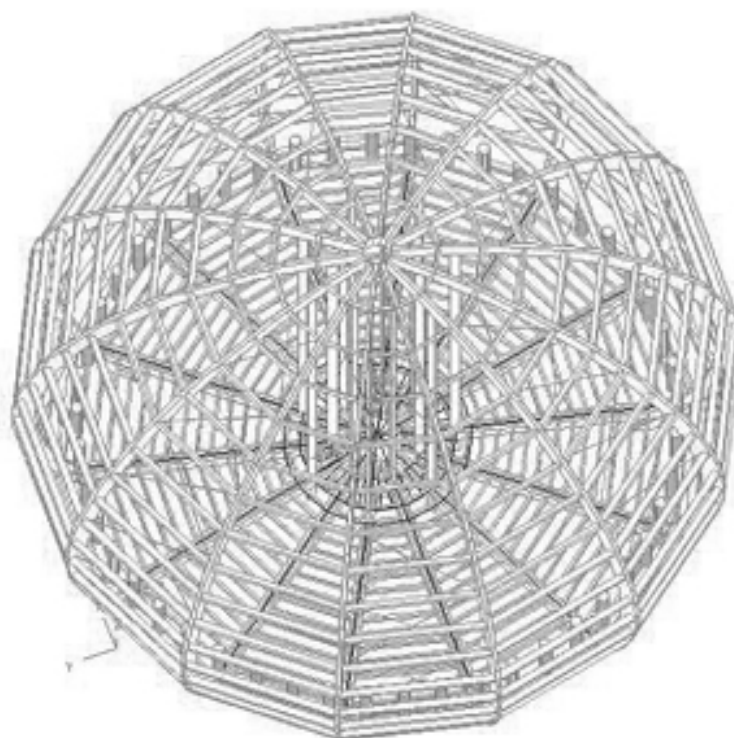
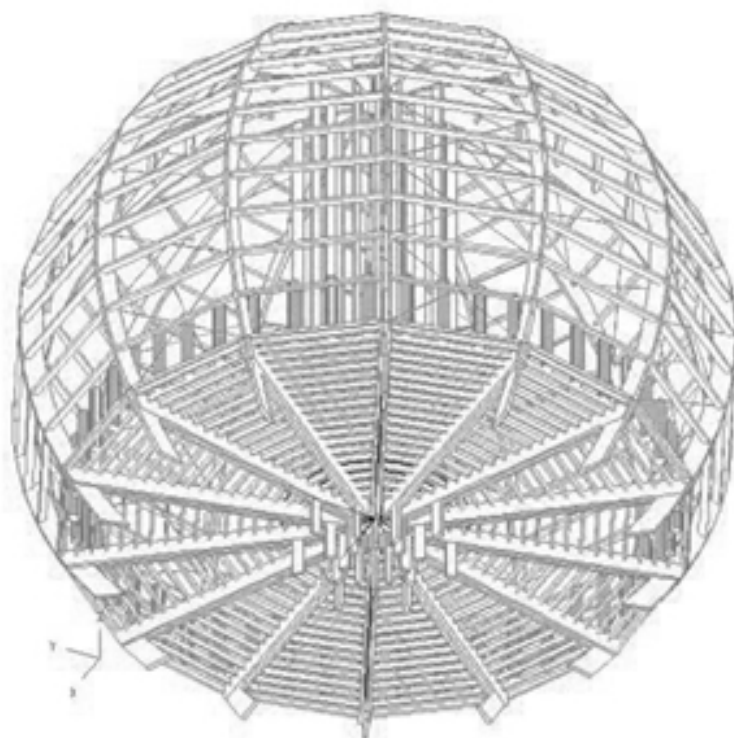

**Estrutura
madeira lamelada colada
"Glulam-Flexilam"**

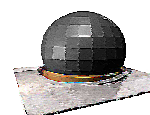

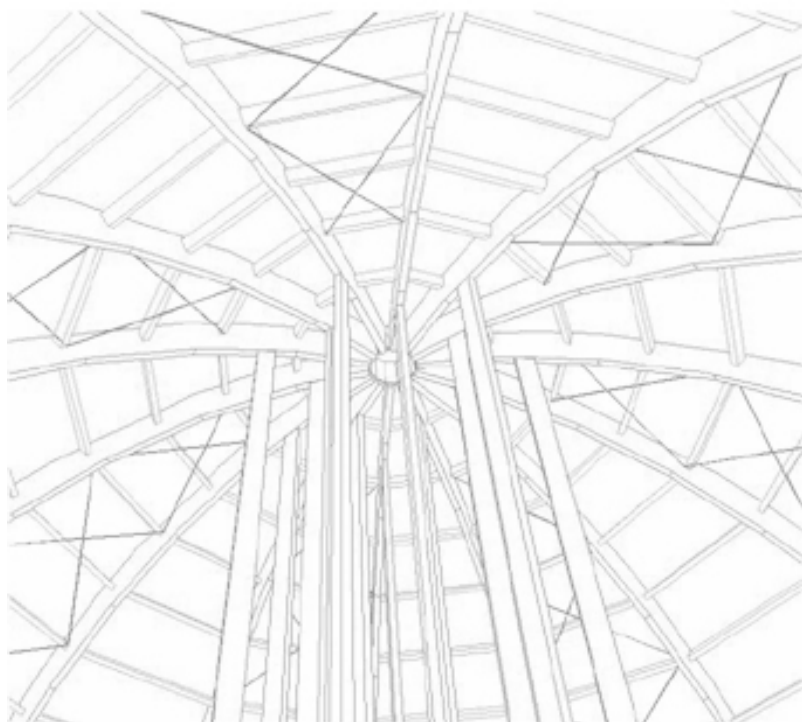

**Estrutura
madeira lamelada colada
"Glulam-Flexilam"**

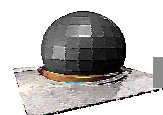

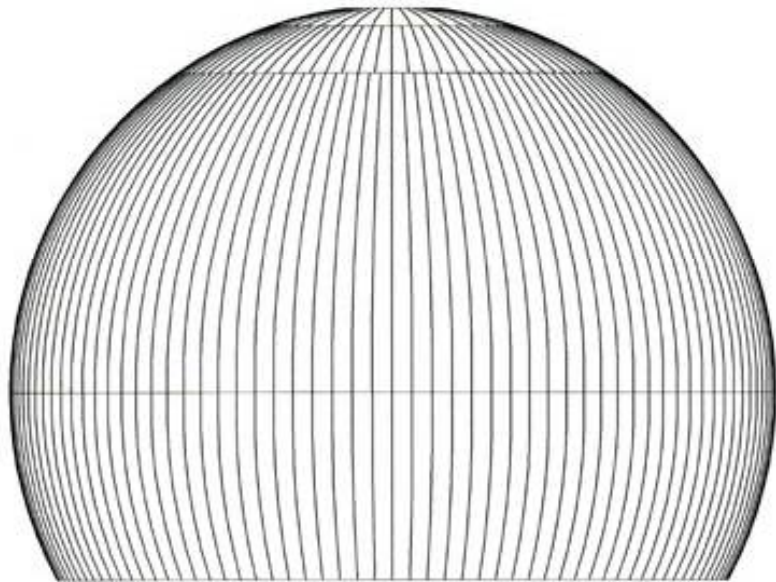
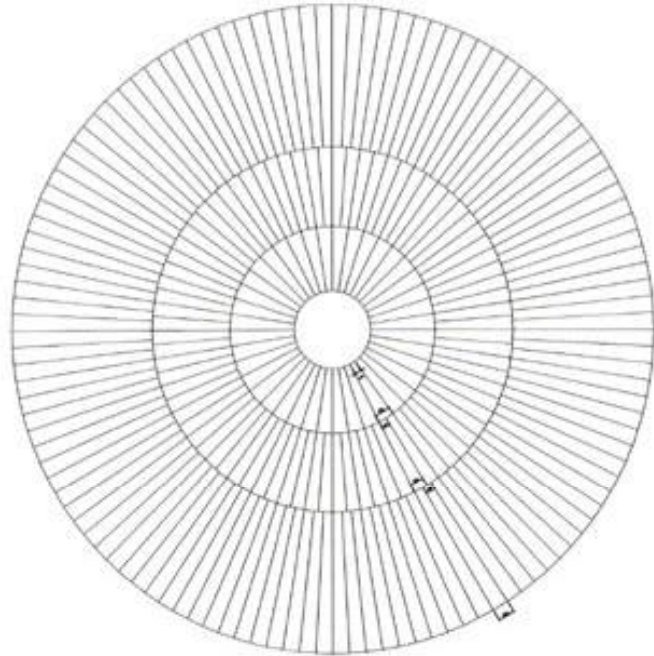

COBERTURA
bandejas de alumínio martelado
"Kalzip-Corus"

